



# Property Information Report

City of Lynchburg Assessor's Office  
 900 Church Street  
 Lynchburg, VA 24504  
 Telephone: (434) 455-3830  
 8:30a.m. - 5:00 p.m. Mon - Fri

**Parcel ID:** 05506055  
**Property Address:** 4897 FORT AVE  
 LYNCHBURG, VA 24502

**Owner:** SIWEK, DONALD J & THERESA M  
**Mailing Address:** 1181 OLD STATION FARM RD  
 FOREST, VA 24551-3132

Property Descriptions	
<b>Legal Description:</b>	COMMONLY KNOWN AS 4897 FORT AVE;
<b>Neighborhood:</b>	7102 : WARDS RD COMMERCIAL CORRIDOR
<b>Property Class:</b>	406 : COMMERCIAL - SERVICE GARAGE

Land Information	
<b>Area:</b>	Legal Acreage: 0.111 GIS Acreage: 0.114
<b>Frontage:</b>	0.00ft
<b>Depth:</b>	101ft

Special Assessments	
<b>Participant in Land Use:</b>	NO
<b>Land Use Deferral Amount:</b>	--
<b>Participant in Rehab Program:</b>	NO
<b>Exempt Amount:</b>	--
<b>Participant Until:</b>	--

School Zones	
<b>Elementary School:</b>	PERRYMONT ELEMENTARY
<b>Middle School:</b>	PL DUNBAR MIDDLE
<b>High School:</b>	HERITAGE HIGH
<b>Zoning:</b>	<b>Zoning Description:</b>
B-3	Community Business

## Ownership History

Sale Date	Sale Amount	Seller's Name	Buyer's Name	Document No	Deed Bk / Pg	Conveyance
7/1/1998	\$100,000	TOLLEY, OMA F JR & JOYCE H	SIWEK, DONALD J & THERESA M		1043 701	
3/4/1997	\$102,700	CORSALE, SAM & BETTY J	TOLLEY, OMA F JR & JOYCE H		985 603	
2/10/1992	\$54,000	TOLLEY, OMA F JR & JOYCE H	CORSALE, SAM & BETTY J		812 700	
1/1/1926	\$0	CAMPBELL COUNTY ANNEXATION 1926				

## Assessment

Year	Land Value	Improvement Value	Total Value
2013	\$44,000	\$69,300	\$113,300
2012	\$44,000	\$69,300	\$113,300
2011	\$44,000	\$69,300	\$113,300
2010	\$44,000	\$69,300	\$113,300
2009	\$44,000	\$69,300	\$113,300
2008	\$44,000	\$68,100	\$112,100
2007	\$44,000	\$68,100	\$112,100
2006	\$44,000	\$56,400	\$100,400
2005	\$44,000	\$56,400	\$100,400
2004	\$44,000	\$57,900	\$101,900
2003	\$44,000	\$57,900	\$101,900

DISCLAIMER: This data is provided without warranty of any kind, either expressed or implied, including but not limited to, the implied warranties of merchantability and fitness for a particular purpose. Any person, firm or corporation which uses this map or any of the enclosed information assumes all risk for the inaccuracy thereof, as the city of Lynchburg expressly disclaims any liability for loss or damage arising from the use of said information by any third party.

## Real Estate Property Tax Information

**Total Due:  
\$628.83**

Current Year	Type	Date Due	Tax Billed	Penalty Billed	Interest Billed	Tax Paid	Penalty Paid	Interest Paid	Date Paid	Balance Due
Installment #:1	Tax	11/15/13	\$314.40	\$0.00	\$0.00	\$314.40	\$0.00	\$0.00	11/20/2013	\$0.00
Installment #:2	Tax	01/15/14	\$314.40	\$0.00	\$0.00	\$314.40	\$0.00	\$0.00	1/16/2014	\$0.00
Installment #:3	Tax	03/17/14	\$314.40	\$0.00	\$0.00	\$0.00	\$0.00	\$0.00		\$314.40
Installment #:4	Tax	05/15/14	\$314.43	\$0.00	\$0.00	\$0.00	\$0.00	\$0.00		\$314.43

History	Type	Tax Billed	Penalty Billed	Interest Billed	Tax Paid	Penalty Paid	Interest Paid	Date Paid	Balance Due
2012	Tax	\$1,257.63	\$0.00	\$0.00	\$1,257.63	\$0.00	\$0.00	5/21/2013	\$0.00
2011	Tax	\$1,189.65	\$29.74	\$0.00	\$1,189.65	\$29.74	\$0.00	5/17/2012	\$0.00
2010	Tax	\$1,189.65	\$0.00	\$0.00	\$1,189.65	\$0.00	\$0.00	5/17/2011	\$0.00
2009	Tax	\$1,189.65	\$0.00	\$0.00	\$1,189.65	\$0.00	\$0.00	5/18/2010	\$0.00
2008	Tax	\$1,177.05	\$0.00	\$0.00	\$1,177.05	\$0.00	\$0.00	5/18/2009	\$0.00
2007	Tax	\$1,177.05	\$29.43	\$0.50	\$1,177.05	\$29.43	\$0.50	5/15/2008	\$0.00
2006	Tax	\$1,114.44	\$0.00	\$0.00	\$1,114.44	\$0.00	\$0.00	5/16/2007	\$0.00
2005	Tax	\$1,114.44	\$0.00	\$0.00	\$1,114.44	\$0.00	\$0.00	5/16/2006	\$0.00
2004	Tax	\$1,131.09	\$0.00	\$0.00	\$1,131.09	\$0.00	\$0.00	5/18/2005	\$0.00
2003	Tax	\$1,131.09	\$0.00	\$0.00	\$1,131.09	\$0.00	\$0.00	5/18/2004	\$0.00
2002	Tax	\$721.50	\$18.04	\$0.15	\$721.50	\$18.04	\$0.15	5/19/2003	\$0.00
2001	Tax	\$721.50	\$0.00	\$0.00	\$721.50	\$0.00	\$0.00	5/21/2002	\$0.00
2000	Tax	\$666.00	\$0.00	\$0.00	\$666.00	\$0.00	\$0.00	5/18/2001	\$0.00
1999	Tax	\$666.00	\$0.00	\$0.00	\$666.00	\$0.00	\$0.00	5/17/2000	\$0.00
1998	Tax	\$555.00	\$0.00	\$0.00	\$555.00	\$0.00	\$0.00	5/20/1999	\$0.00
1997	Tax	\$555.00	\$0.00	\$0.00	\$555.00	\$0.00	\$0.00	5/11/1998	\$0.00
1996	Tax	\$456.21	\$0.00	\$0.00	\$456.21	\$0.00	\$0.00	5/13/1997	\$0.00
1995	Tax	\$464.43	\$0.00	\$0.00	\$464.43	\$0.00	\$0.00	5/10/1996	\$0.00
1994	Tax	\$476.76	\$0.00	\$0.00	\$476.76	\$0.00	\$0.00	5/10/1995	\$0.00
1993	Tax	\$476.76	\$11.91	\$0.00	\$476.76	\$11.91	\$0.00	5/16/1994	\$0.00

## Recent Sales Information by Neighborhood

Parcel ID	Property Address	Recorded Sale Date	Sale Amount	Seller's Name	Buyer's Name	Document Num
25703019	3810 WARDS RD	3/6/2014	\$0	ADAMS, KEITH TRS	ADAMS, KEITH TRS & ADAMS, KIM D TRS	140001157
05509062	5212 FORT AVE	3/4/2014	\$100,000	ANTHONY, JOHN M & DEBRA R	H&B PROPERTIES LLC	140001084
05509063	5210 FORT AVE	2/26/2014	\$590,000	JUNG, BOOHONG & YOUNGJUNG CHOI	ABARZUA, MARIO ANTONIO V	140001006
16228019	2533 WARDS RD	2/6/2014	\$280,000	CLARKSON, BARRY D	MAYS, WILLIAM N JR	140000673
16003011	5600 EDGEWOOD AVE	1/23/2014	\$0	DANIEL, LARRY R & JUDITH M	DANIEL, LARRY R & JUDITH M CO-TRS	140000388
25702001	4005 WARDS RD	1/13/2014	\$10	SPIRIT MASTER FUNDING V LLC	SPIRIT MASTER FUNDING VII LLC	140000185
16203001	5604 SEMINOLE AVE	1/7/2014	\$2,560,000	CHOICE INN INC	LAKSHMI MAA INC	140000090
16201065	2815 CANDLERS MOUNTAIN RD	10/31/2013	\$3,500,000	FRANCIS HOSPITALITY INC	JAY SHREE DUTT LLC	130007917
16201069	2308 WARDS RD	10/31/2013	\$3,500,000	FRANCIS HOSPITALITY INC	JAY SHREE DUTT LLC	130007917
05507032	1101 TOLEDO AVE	10/21/2013	\$65,700	HOUSING & URBAN DEVELOPMENT	PARKS PROPERTIES LLC	130007641
25802001	3770 CANDLERS MOUNTAIN RD	10/16/2013	\$0	CITY OF LYNCHBURG	LIBERTY UNIVERSITY INC	130007521
25705019	1038 WARDS FERRY RD	9/30/2013	\$650,000	BACK YARD REAL ESTATE LLC	RODGERS FAMILY HOLDINGS LLC	130007185
25702001	4005 WARDS RD	8/27/2013	\$3,641,171	CORRAL GROUP OF VIRGINIA LLC	SPIRIT MASTER FUNDING V LLC	130006305
16103012	1001 SHEFFIELD DR	8/23/2013	\$0	BEASLEY, HAROLD B & EVELYN J	BEASLEY, EVELYN J	130000232
16202025	5704 SEMINOLE AVE	7/1/2013	\$600,000	CAROLINA BANK	SEMINOLE HOSPITALITY LLC	130004786
05507032	1101 TOLEDO AVE	7/1/2013	\$133,846	BANK OF AMERICA N A	HOUSING & URBAN DEVELOPMENT	130004770
16002006	2117 WARDS RD	6/28/2013	\$650,000	L & W PROPERTIES OF VA	TWO BOYS REALTY LLC	130004734
25703019	3810 WARDS RD	6/20/2013	\$1,978,000	A R T HOLDING LLC	ADAMS, KEITH TRS	130004502
16201065	2815 CANDLERS MOUNTAIN RD	4/30/2013	\$2,500,000	CRIST MOTEL INC	FRANCIS HOSPITALITY INC	130003094
16201069	2308 WARDS RD	4/30/2013	\$2,500,000	CRIST MOTEL INC	FRANCIS HOSPITALITY INC	130003094
26003011	4017 WARDS RD	1/15/2013	\$950,000	TCB FOODS INC	ABBITT BROTHERS PROPERTIES LLC	130000389
13002024	3756 CANDLERS MOUNTAIN RD	12/28/2012	\$458,000	SUNDAE GRILL HOLDINGS LLC	LU CANDLERS STATION HOLDINGS LLC	120008704
16103014	1003 SHEFFIELD DR	12/20/2012	\$200,000	FIRST PROPERTIES INC	KESSLER INVESTMENT GROUP INC	120008531
05509057	5224 FORT AVE	11/21/2012	\$260,000	SHUMAN, DAVID B REVOCABLE TRUST	RIPL LLC	120007793
16206007	3385 CANDLERS MOUNTAIN RD	10/24/2012	\$6,900,000	SEARS ROEBUCK & COMPANY	LIBERTY UNIVERSITY INC	120007082
05507032	1101 TOLEDO AVE	10/19/2012	\$133,846	IQBAL, ASHER	BANK OF AMERICA N A	120006988
16103014	1003 SHEFFIELD DR	9/25/2012	\$275,000	HINDS ROTHMAN & COMPANY LLC	FIRST PROPERTIES INC	120006351
11703001	3320 CANDLERS MOUNTAIN RD	9/21/2012	\$2,600,000	OFFICE PARKS OF VIRGINIA INC	COMEBACK INN LLC	120006228
13002001	3762 CANDLERS MOUNTAIN RD	8/17/2012	\$1,750,000	CUBE ENTERPRISES LLC	LIBERTY UNIVERSITY INC	120005452
13002014	3760 CANDLERS MOUNTAIN RD	8/17/2012	\$1,750,000	CUBE ENTERPRISES LLC	LIBERTY UNIVERSITY INC	120005452

DISCLAIMER: This data is provided without warranty of any kind, either expressed or implied, including but not limited to, the implied warranties of merchantability and fitness for a particular purpose. Any person, firm or corporation which uses this map or any of the enclosed information assumes all risk for the inaccuracy thereof, as the city of Lynchburg expressly disclaims any liability for loss or damage arising from the use of said information by any third party.

**Improvement: COMMERCIAL SERVICE GARAGE**



01

02

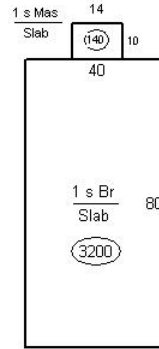

**Service Garage:001**

**Year:** 1928  
**Size:** 3340  
**Stories:** 1

**Heated Area:** 0  
**Frame:** Fire Resistant  
**Roof Description:** BUILT-UP  
**Rooms:** 0

**Paving**

**Year:** 1928  
**Size:** 3500

**Residential Shed - Small Utility**

**Year:** 1980  
**Size:** 240

# The City of Lynchburg, VA

## Legend

Street Labels



Feet

0 20 40 60 80  
1:1,200 / 1"=100 Feet

3/12/2014

DISCLAIMER: This drawing is neither a legally recorded map nor a survey and is not intended to be used as such. The information displayed is a compilation of records, information, and data obtained from various sources, and the City of Lynchburg is not responsible for its accuracy or how current it may be.

